

SKETCH ADDENDUM

Borrower or Owner N/A
 Property Address #22, 644 HARBOR CREEK DRIVE
 City CHARLESTON County CHARLESTON State SC Zip Code 29412
 Lender or Client HANDSOME PROPERTIES, INC

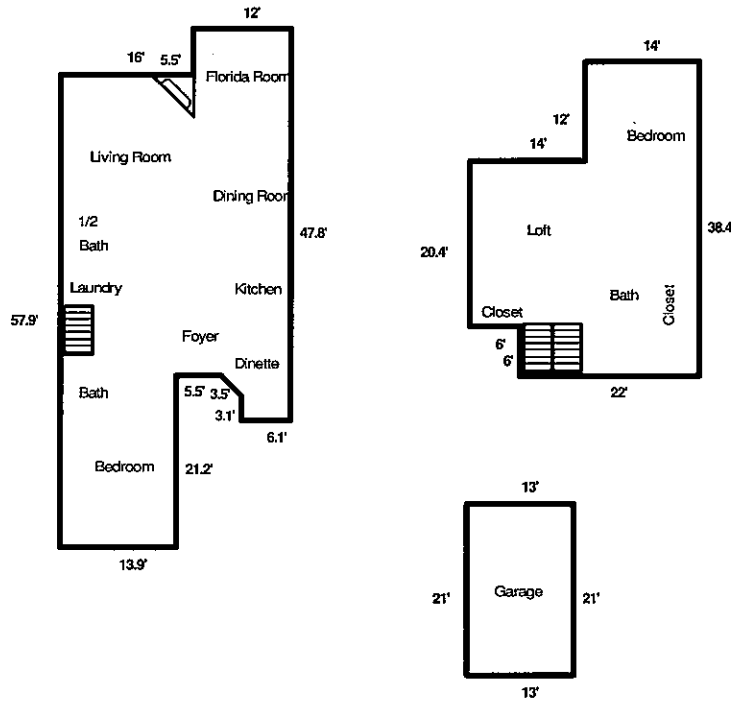

SUMMARY	SQ FT AREA	PERIMETER	AREA CALCULATION DETAILS
Living Area			
First Floor	1425	193	12.0 X 5.5 = 66.0
Second Floor	871	133	28.0 X 36.7 = 1027.6
Total	2296	325	7.3 X 2.5 = 18.2
Garage/Carport			13.9 X 21.2 = 294.6
Attached Garage	273	68	6.1 X 3.1 = 18.9
			Total 1425.3
			Second Floor
			14.0 X 38.4 = 537.6
			14.0 X 20.4 = 285.6
			8.0 X 6.0 = 48.0
			Total 871.2

GOODSON APPRAISAL SERVICES, INC. CLAY R HARRELSON

REAL EASY SKETCHES 1-803-967-2833