

SKETCH ADDENDUM

Borrower or Owner	HANDSOME PROPERTIES				
Property Address	423 SUMTER ST				
City	CHARLESTON	County	CHARLESTON	State	SC
Zip Code	20403				
Client	HANDSOME PROPERTIES, INC				

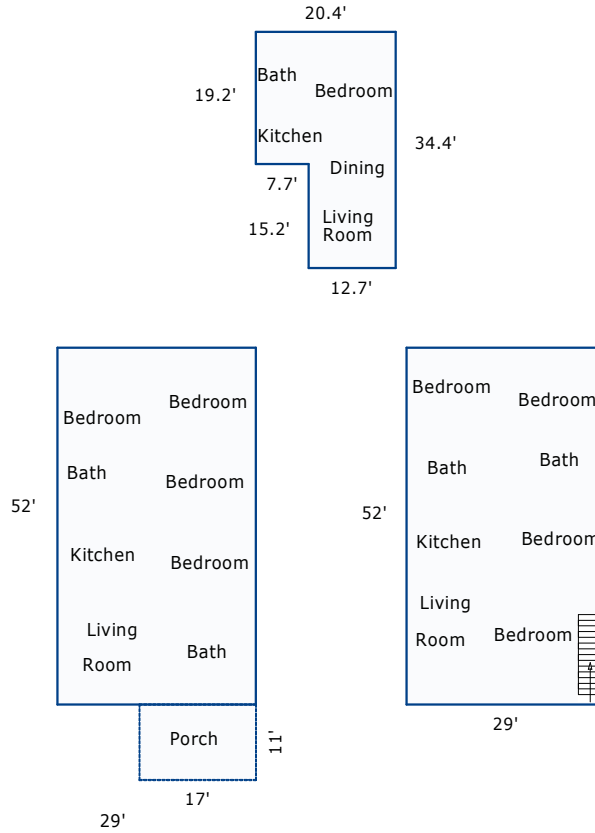

Sketch by Apex Medina™

Comments:

AREA CALCULATIONS SUMMARY			
Code	Description	Net Size	Net Totals
GLA1	First Floor	1508.0	
	Second Floor	1508.0	
	Carriage House First	584.7	3600.7
P/P	Porch	187.0	187.0
Net LIVABLE Area		(rounded)	3601

LIVING AREA BREAKDOWN		
	Breakdown	Subtotals
First Floor		
	29.0 x 52.0	1508.0
Second Floor		
	29.0 x 52.0	1508.0
Carriage House First		
	20.4 x 19.2	391.7
	15.2 x 12.7	193.0
4 Items	(rounded)	3601